



SPLIT-SHAFT UNIT 2000 KGM 3.2.90.1.
3000 KGM 3.2.90.2.



- ✓ Inserted in the driveshaft between gearbox and rear axle.
- ✓ PTO torque capability: 130 kgm max each output shaft at 1500 rpm.
- ✓ Four - two to front, two to rear - independently shiftable PTO's for hydraulic pumps or prop-shaft drive.
- ✓ "Constant-mesh" output options on request.
- ✓ Clutch unit p.n. 3.5.1.068.0000 capable of 60 kgm suitable for "constant-mesh" output direct mounting.
- ✓ Auxiliary power available with the vehicle in motion.
- ✓ Drive connection to rear axle independent on PTO operation.
- ✓ Provision for electronic tachograph (Mannesmann VDO type):
code 0.99.00.737.00 (dynamic with faston-type joint),
code 0.99.00.738.00 (static with faston-type joint),
code 0.99.00.739.00 (static with plug type joint).
- ✓ Provision for switch for warn light when main drive is disconnected.
- ✓ Max throughput rpm: **3.500 rpm**

TORQUE RATING THROUGH THE MAIN DRIVE SHAFT:

2000 kgm for 3.2.90.1

3000 kgm for 3.2.90.2

AVAILABLE PTO OUTPUT RATIOS: 1,28:1

ROTATION: opposite engine

WEIGHT 3.2.90.1: kg. 103 (without flanges)

3.2.90.2: kg. 106 (without flanges)

3.2.90.X.2.XX.XX

BASIC SERIAL NUMBER

TORQUE RATING THROUGH THE MAIN DRIVE SHAFT

1 = 2000 KGM

2 = 3000 KGM

RIGHT AXEL OUTPUT SHAFT OPTIONS (REAR VIEW)

02 = FRONT/REAR STANDARD ISO 4 BOLT OUTPUT

10 = REAR ISO 4 BOLT OUTPUT / FRONT CONSTANT-MESH OUTPUT

11 = FRONT ISO 4 BOLT OUTPUT / REAR CONSTANT-MESH OUTPUT

12 = FRONT/REAR CONSTANT-MESH OUTPUT

LEFT AXEL OUTPUT SHAFT OPTIONS (REAR VIEW)

02 = FRONT/REAR STANDARD ISO 4 BOLT OUTPUT

10 = REAR ISO 4 BOLT OUTPUT / FRONT CONSTANT-MESH OUTPUT

11 = FRONT ISO 4 BOLT OUTPUT / REAR CONSTANT-MESH OUTPUT

12 = FRONT/REAR CONSTANT-MESH OUTPUT

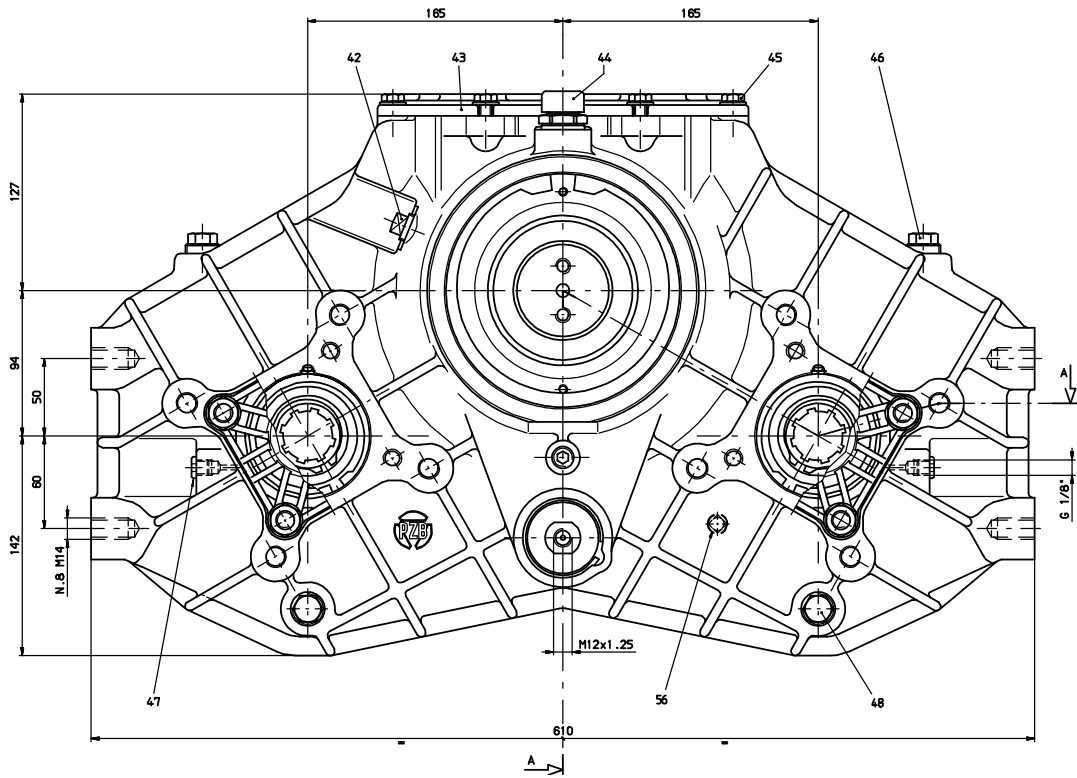

VERSION 3.2.90.1.

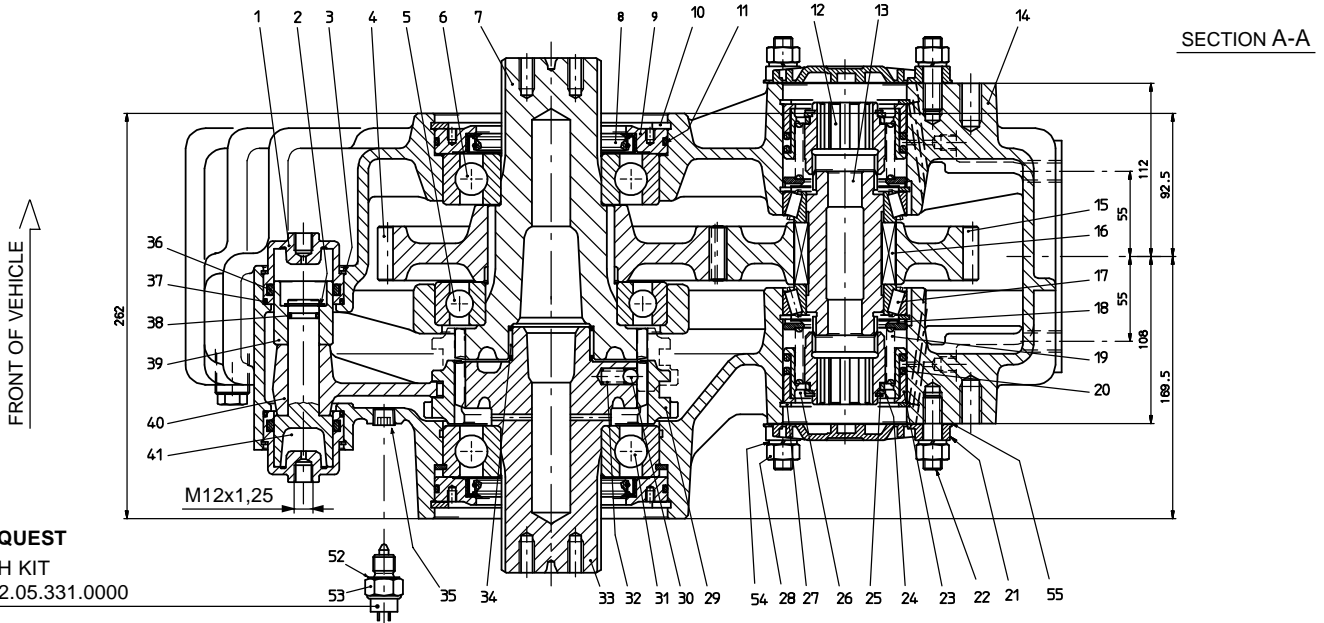

VERSION 3.2.90.2.

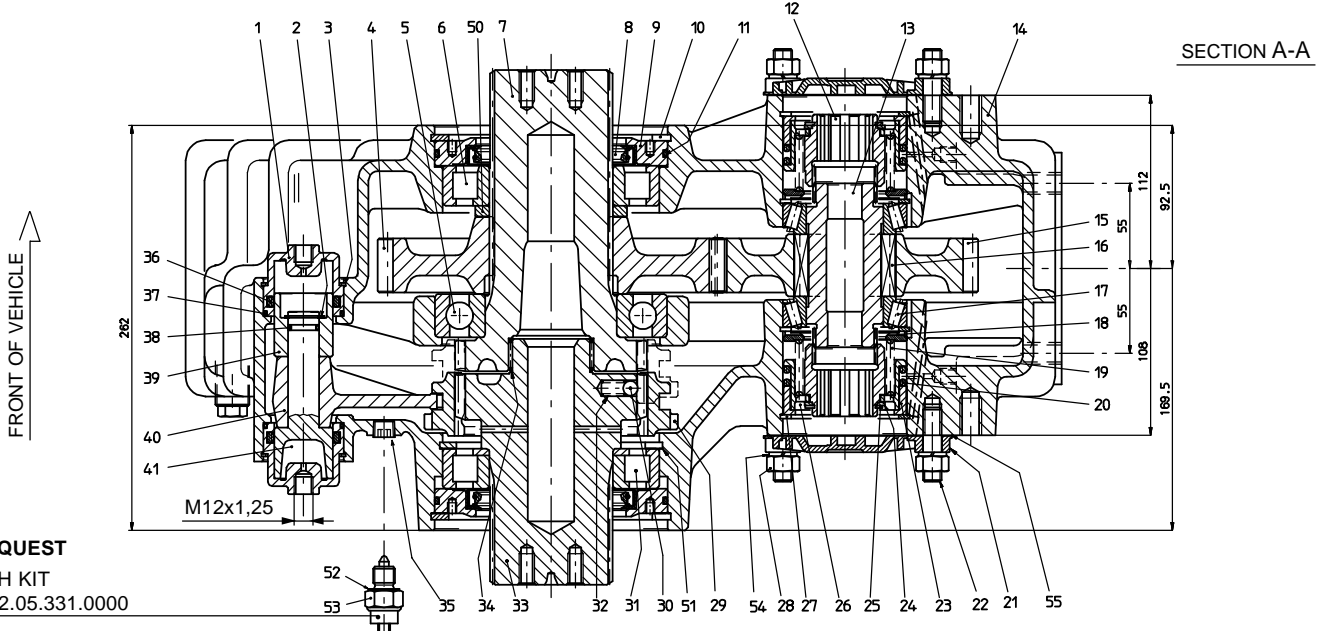

REF.	CODE	DESCRIPTION	QT.	REF.	CODE	DESCRIPTION	QT.
1	1.08.01.001.00	Cylinder 218B/5	2	29	1.17.02.080.00	Splined sleeve	1
2	0.07.01.022.00	Circlip 20e UNI 7435	1	30	0.11.01.002.00	Ball 3/8"	3
3	0.07.05.002.00	Circlip SB52	2		0.10.01.041.00	Bearing 6313NR (P.T.O. 3.2.90.1)	
	1.11.03.107.00	Gear 50 T (P.T.O. 3.2.90.1)		31	0.10.03.022.00	Bearing NUP 216 (P.T.O. 3.2.90.2)	1
4	1.11.03.109.00	Gear 50 T (P.T.O. 3.2.90.2)	1	32	1.28.01.006.00	Coil spring mod.15	3
5	0.10.01.042.00	Bearing 6217	1		1.13.01.152.00	Shaft (P.T.O. 3.2.90.1)	
	0.10.01.040.00	Bearing 6313 (P.T.O. 3.2.90.1)		33	1.13.01.162.00	Shaft (P.T.O. 3.2.90.2)	1
6	0.10.03.021.00	Bearing NJ 216 (P.T.O. 3.2.90.2)	1		0.10.06.017.00	Needle cage K50x55x20H	
	1.13.01.151.00	Shaft (P.T.O. 3.2.90.1)		34	0.12.01.077.00	Plug M14x1,5 DIN 906	1
7	1.13.01.161.00	Shaft (P.T.O. 3.2.90.2)	1	35	0.08.02.137.00	O-Ring OR 6150 Viton	2
	0.08.01.091.00	Seal 90x110x12 Viton		36	0.08.02.138.00	O-Ring OR 3187 Viton	2
8	1.27.02.122.00	Ring	2	37	0.08.02.136.00	O-Ring OR 119 Viton	1
9	0.07.02.046.00	Circlip 150i UNI 7437	2	38	1.21.02.038.00	Piston	1
10	0.08.02.140.00	O-Ring OR 4562 Viton	2	39	1.22.01.044.00	Fork	1
11	1.17.02.071.00	Splined sleeve	4	40	1.21.01.030.00	Piston	1
12	1.13.02.040.00	Shaft	2	41	0.12.01.049.00	Plug 18x1,5 FIAT 1/43236/11	1
13	1.01.05.010.00	Housing	1	42	1.24.01.094.00	Cover	1
14	1.11.10.108.00	Gear 39 T	2	43	0.12.01.115.00	Filler-breather G1/2"	1
15	0.06.01.018.00	Key 14x9x40 UNI 6604 - type "B"	2	44	0.01.01.076.00	Capscrew TE with flange M8x20 DIN 6921	6
16	0.10.05.027.00	Bearing 32010X	4	45	0.12.01.065.00	Plug 22x1,5 FIAT 1/43244/11	2
17	1.26.01.132.00	Ring	4	46	0.12.01.059.00	Plug U-908G1/8	4
18	1.28.01.075.00	Coil spring	4	47	0.12.01.002.00	Plug FIAT 1/43262/11	2
19	0.08.02.119.00	O-Ring OR 6275 Viton	8	48	1.26.01.122.00	Spacer (P.T.O. 3.2.90.2)	1
20	1.24.01.113.00	Cover	4	49	0.07.02.047.00	Circlip 140i UNI 7437 (P.T.O. 3.2.90.2)	1
21	0.02.02.031.00	Stud M12x30 UNI 5911	16	ON REQUEST: KIT SWITCH 2.05.331.0000			
22	1.27.02.079.00	Ring	4	52	0.04.01.108.00	Washer 14,5x20x0,5	1
23	1.26.01.085.00	Spacer	4	53	0.99.00.160.00	Indicator switch	1
24	0.07.01.016.00	Circlip 42e UNI 7435	4		0.04.08.002.00	Lockwasher 12,5 DIN 7980	16
25	1.21.02.025.00	Piston	4	54	1.29.01.131.00	Gasket	4
26	0.07.02.012.00	Circlip 80i UNI 7437	8	55	0.12.01.114.00	Oil level plug	1
27	0.03.01.019.00	Hex nut M12 ch. 17	16	56			

**ON REQUEST:
DOUBLE-ACTING AIR CONTROL TO CONNECT/DISCONNECT MAIN DRIVE
CODE 0.00.04.023.00**

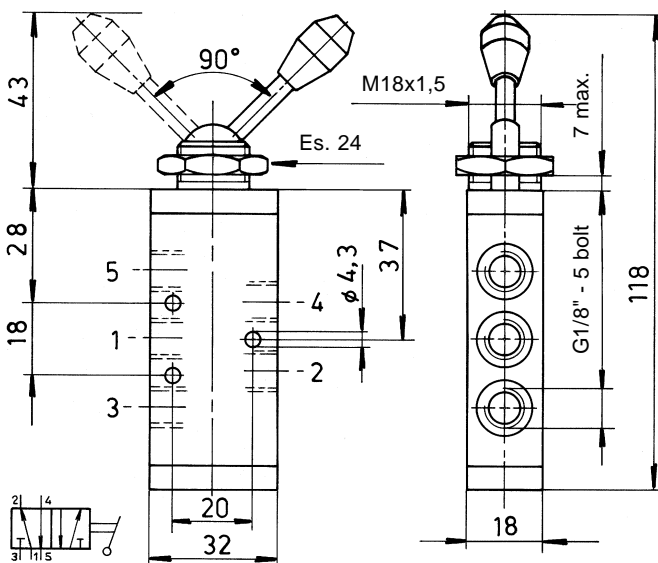

SPECIFICATIONS

Fluid:	Air, filtered and oiled
Operating pressure:	10 Bar max.
Operating temperature:	from -5°C to +70°C

ON REQUEST: MOUNTING BRACKET KIT CODE 2.99.101.0000

Mounting kits are available for easy installation of the 3.2.90.1 and 3.2.90.2 Split-Shaft Units in the truck chassis.

The kit includes brackets and elastic suspension elements.

